

AUTHORITY

The event shall be conducted under the International sporting code of the FIA, the National Competition Rules (NCR) of the Confederation of Australian Motor Sport Ltd. (CAMS), Passenger in vehicle guidelines, the Speed Event Standing Regulations, the Non Competitive Speed Event Regulations, these Supplementary Regulations and any other further instructions which may be issued, and will be subject to CAMS Permit Number 710/2305/01

The event will be conducted under and in accordance with the CAMS OH&S and Risk Management Policies, which can be found at www.cams.com.au

EVENT DESCRIPTION

The Light Car Club of Tasmania will be conducting a Club speed event (herein referred to as "the event") on 23/05/2010 at Symmons Plains Raceway over a distance of 2.41km in an anti clockwise direction. The event will consist of 'Observation Laps' (passenger allowed) followed by 1, three lap 'Timed Session', consisting of one warm up lap, 1 (one) timed lap and one cool down lap. At the discretion of the event organisers 4 (four) lap 'Super Sprints' will follow. 'Super Sprints' will be conducted with up to 8 cars starting from a 2 x 4 grid. Once the first 2 cars are a suitable distance along the track a second pair of cars will be started. There will be a maximum of 10 cars on the circuit at any given time. All 'Super Sprints' will be timed over 4 laps and the driver completing the 'Super Sprint' with the lowest elapsed time will be deemed the winner. The event will commence at 9 am and finish at 6 pm.

PROMOTERS

Light Car Club of Tasmania
PO Box 723, Launceston, 7250.
Phone: 6344 5665 (bh) 6340 1795 (ah) Fax: 6343 0466
e-mail: info@lcct.org.au Web: www.lcct.org.au

CLUBS INVITED TO COMPETE

a) Light Car Club of Tasmania

ORGANISING COMMITTEE & OFFICIALS

Clerk of Course	Rosemary Taylor
Event Secretary	John Palmer
Chief Scrutineer	David McPharlin
Chief Flag Marshall	Kevin Burt
Starter	Bradley Newell
General Officials	Kim Taylor, Robert Marshall, George Kourtis, Tony McGuinness, Brian Dunstan.
Stewards	Craig Twining, John Hartley.
Organising Committee	Kim Taylor, Rosemary Taylor, John Palmer, Robert Marshall, Norma Marshall, David McPharlin, Tony McGuinness.

Failure to follow the direction of any official may render a competitor liable to exclusion from the event.

ENTRIES

Cheques and money orders should be made payable to LCCT. Entries paid by cheque are not contractual until the cheque is honoured.

SCRUTINY

Scrutiny will commence in the Scrutiny Bay at 9 am on the day of the event. All cars must attend and pass scrutiny prior to the event. **Current Club Membership Cards**, CAMS Level 2S or higher **licence**, competition

record and helmet must be presented at scrutiny. Cars must be presented at scrutiny with **log book (if issued)** in track ready condition.

DRIVERS BRIEFING

Drivers Briefing will commence at the Control Tower at 10.30 am on the day of the event. All competitors are to attend the compulsory drivers briefing in the scrutiny bay or other nominated place on the day. Failure to attend this briefing on time may result in the competitors being excluded from the event and the forfeiture of any entry fee.

CLASSES, TIMING, RESULTS & TROPHIES

Entries open	20/04/2010
Entries close	23/05/2010
Maximum no. of entries	100
Maximum no. of vehicles permitted on the circuit	10

Entry fee, Drivers and Relief Drivers:

If received on or before	17/05/2010	\$ 110 Each
If received before	10am 23/05/2010	\$ 125 Each
If received thereafter		\$ 150 Each
Pit lane garage <i>per car</i> , 2 cars per garage		\$ 15 Each

Any competitor supplying an event official, over the age of 14 years, for a minimum of 3 hours assistance will receive a refund of \$10 off their entry fee at the end of the event. These people must sign-on with the Clerk of Course at the commencement of their assistance and sign-off at the completion of their duties.

The promoter reserves the right to refuse any entry (NCR83)

Class A, B, C, D and E. (as per LCCT Standing Orders)
Any class that attracts less than three (3) competitors may be amalgamated with other classes at the discretion of the organisers.

The following prizes / trophies / series points shall be awarded at the discretion of the promoters:

- **Club Points**
- **Trophies for Driver of the Day, Best Presented Car, Most Improved Driver.**

The promoter reserves the right to refuse entry in accordance with NCR83.

Timing will be by electronic means and the Clerk of Course is deemed Judge of Fact.

Insurance will be provided in accordance with Appendix I of the CAMS Manual.

PROTEST

Any protest must be lodged in accordance with Part xii of the NCR

ABANDONMENT, ALTERATION & SUSPENSION

The promoters and the Clerk of Course reserve the right to abandon, cancel, alter or postpone the event in accordance with NCR 59 or to temporarily suspend the event for any reason.

DRIVERS, PASSENGER

All competitors and drivers must hold a current CAMS Level 2S licence or superior and be a member of a CAMS Affiliated Club. One passenger, who may not be a member of the Drivers' immediate family, may be permitted in each car during the 'Observation Laps'. Passengers must sign the appropriate indemnity form and are reminded that they **ARE NOT** covered by CAMS Insurance. The vehicle must also be kept to less than competition speeds.

APPAREL

Drivers and passengers must be attired in long legged trousers and long sleeved shirts or tops made of a non-flammable material. Suitable footwear is required (no thongs, sandals or high heeled boots/shoes.)

Drivers and passengers must wear a helmet, which complies with AS 1698 (or as otherwise listed in Schedule D of the 2010 CAMS Manual of Motor Sport, and available at www.camsmanual.com.au) at all times whilst on the track.

CAMS ANTI-DOPING POLICY

During any competition, consumption of alcoholic beverages in the paddock, pits or any other portion of the competition venue under the control of the officials is expressly forbidden until all practice or competition activity is concluded for each day. Any driver or crew member who is found to be affected by alcohol on the day of the event or practice therefore shall not be permitted to participate. Refer NCR 145A. In addition, the persons concerned will be subject to the Articles of the Procedure for Alcohol Testing and CAMS Drugs in Sport Policy. Competitors, crews or officials may be tested for alcohol or other drugs at any time during the event(s).

VEHICLE EQUIPMENT & SAFETY

All vehicles must comply with section 6, schedules A and B. of the 2010 CAMS Manual of Motor Sport.

- a) Must be fitted with seat belts **and safety harness** of a type listed in Schedule I of the 2010 CAMS Manual of Motor Sport (i.e. AS2596, ADR 4/00 or 4/01, AS E35, SFI 16.1, FIA Standard 8853/98, 8853-1985, 8854-1991 or 8854/98 or European Standard ECE R16). Competitors are reminded that where required by the relevant standard (FIA 8853/98, 8854/98, SFI16.1), seat belts need to comply with age requirements.
- b) Must be fitted with a fire extinguisher of at least 900g capacity, which complies with AS 1841 and Schedule H of the CAMS current Manual of Motor Sport. (Note that extinguishers complying with AS1841.2 are not permitted) properly fitted at a suitable location. Extinguishers will be inspected by Scrutineers before the event as per Schedule H – 5, this will include inspection of the unit and its mountings for damage, checking the pressure of the contents, and shaking the container to check for settling of the contents. It is highly recommended that the extinguisher be presented with a current inspection tag.
- c) All vehicles must have all forward facing glass, except for the windscreen, covered with a transparent adhesive film, as per Schedule B – 16 of the 2010 CAMS Manual of Motor Sport.
- d) Tail shaft strap or loop to prevent tail shaft hitting the ground in the event of breakage is required for cars that are not road registered and strongly recommended for road registered cars, as per Schedule B – 5 of the 2010 CAMS Manual of Motor Sport.
- e) All vehicles fitted with an opening front panel (eg. Bonnet) must be fitted with a bonnet strap, bonnet pin/s, car bra or similar acceptable device in addition to the normal bonnet restraining system. This device

must be of a non stretch material, as per Schedule B – 1 of the 2010 CAMS Manual of Motor Sport.

- f) Display a blue triangle with sides of 150mm on the coachwork indicating the location of the battery or the battery isolation switch if altered from the original location, as per Schedule B – 14 of the 2010 CAMS Manual of Motor Sport.
- g) All hub caps and removable wheel centres must be removed.
- h) All removable objects including jacks, spare wheels, floor mats etc. must be removed from the vehicle cabin, glove compartment, console and boot.
- i) Road going tyres must be in roadworthy condition. Retread tyres will not be permitted (Racing Slicks are permitted provided they are in race worthy condition).
- j) Whilst a Roll Cage or Roll Over Protection Structure (ROPS) in accordance with Schedule J of the 2010 CAMS Manual of Motor Sport is not mandatory for this event, the Organisers recommend that vehicles be fitted with ROPS. Competitors with a ROPS that does not conform to the current Schedule J standards are referred to Articles 8 and 9 of that schedule. Article 8 of Schedule J advises that ROPS in vehicles issued with a CAMS Log Book, or where the ROPS has been Certified, may continue to be used as long as the ROPS remains in conformity to the CAMS requirements at the date the Log Book or Certification was originally issued. Schedule J of Schedule J advises that 'non-complying roll over protection' is permitted to be used if approval is granted by the Event Stewards. Details of the non-complying ROPS should be included with the entry.
- k) Be fitted with a throttle return spring which will ensure the throttle will always return to the closed position, i.e. dual return springs.
- l) Crank case breathers venting to the atmosphere must be fitted with an oil-trap container as per Schedule B – 2 of the CAMS Manual of Motor Sport, and reprinted in the current CAMS Competitors Handbook (Capacity 2 litres for cars of up to 2,000 cc and 3 litres for other cars)
- m) Any car immobilised on the course will be removed by the promoter and may be subject to scrutiny (at the discretion of the Clerk of Course) before being allowed back on the track.
- n) All vehicles must be adequately muffled to comply with noise restrictions.
- o) **On-Board Cameras.** Any on-board camera shall be mounted in the car at scrutiny and inspected by the Chief Scrutineer. As per Schedule A – 14; Any camera/video recorder of weight greater than 100g and attached other than to the floor must be securely mounted in an aluminium cradle similar to this design.

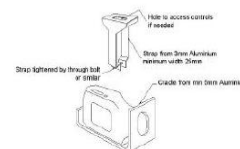

Please refer to [http://www.camsmanual.com.au/techdocs/T-401\[1\].pdf](http://www.camsmanual.com.au/techdocs/T-401[1].pdf) for more detail.

DISCLAIMER

EXCLUSION OF LIABILITY, RELEASE AND ASSUMPTION OF RISK COMPETITORS AND/OR DRIVERS

For Competitors

I/We being the competitor/s of the vehicle described on this Entry Form wish to enter that vehicle for the above event.

For Competitors and Drivers

I/We being the competitor/s and/or driver, certify that the particulars on this form are true and correct in every particular, to the best of my/our knowledge and belief.

I/We declare that I/we have read and understood the Supplementary Regulations issued for the event, and agree to be bound by them and the provisions of the National Competition Rules of the Confederation of Australian Motor Sport Limited ("**CAMS**").

In exchange for being able to attend or participate in the event (including entering the event), I agree:

- to release CAMS and Australian Motor Sport Commission Ltd, promoters, sponsor organisations, land owners and lessees, organisers of the event, their respective servants, officials, representatives and agents (collectively, the "**Associated Entities**") from all liability for my death, personal injury (including burns), psychological trauma, loss or damage (including property damage) ("**harm**") howsoever arising from my participation in or attendance at the event, except to the extent prohibited by law;
- that CAMS and the Associated Entities do not make any warranty, implied or express, that the event services will be provided with due care and skill or that any materials provided in connection with the services will be fit for the purpose for which they are supplied; and
- to attend or participate in the event at my own risk.

I/we acknowledge that:

- the risks associated with attending or participating in the event include the risk that I may suffer harm as a result of:
 - motor vehicles (or parts of them) colliding with other motor vehicles, persons or property;
 - acts of violence and other harmful acts (whether intentional or inadvertent) committed by persons attending or participating in the event; and
 - the failure or unsuitability of facilities (including grand-stands, fences and guard rails) to ensure the safety of persons or property at the event.
- motor sport is dangerous and that accidents causing harm can and do happen and may happen to me.

I accept the conditions of, and acknowledge the risks arising from, attending or participating in the event and being provided with the event services by CAMS and the Associated Entities.

I understand that this disclaimer is not intended to exclude any valid claim I may have under the CAMS Personal Insurance Scheme.

For persons under the age of 18 years the following parent/guardian consent must be completed.

PARENT/ GUARDIAN CONSENT – PERSONS UNDER 18 YEARS OLD

I of [Address] am the parent/ guardian* of the above-named ("the minor") who is under 18 years old. I have read this document and understand its contents, including the exclusion of liability and assumption of risk, and have explained the contents to the minor. I consent to the minor attending / participating in* the event at his/her own risk.

Signed (Parent/Guardian)*: Date:

** Delete whichever does not apply*

SCRUTINEERS REPORT

	Satisfactory	Unsatisfactory		Satisfactory	Unsatisfactory
Safety helmet (AS1698)	<input type="checkbox"/>	<input type="checkbox"/>	Suspension	<input type="checkbox"/>	<input type="checkbox"/>
Driver's apparel	<input type="checkbox"/>	<input type="checkbox"/>	Brakes	<input type="checkbox"/>	<input type="checkbox"/>
Fire Extinguisher	<input type="checkbox"/>	<input type="checkbox"/>	Wheels, tyres	<input type="checkbox"/>	<input type="checkbox"/>
Seat belts	<input type="checkbox"/>	<input type="checkbox"/>	Metal valve caps	<input type="checkbox"/>	<input type="checkbox"/>
Bonnet catches, straps, etc	<input type="checkbox"/>	<input type="checkbox"/>	Accelerator linkage	<input type="checkbox"/>	<input type="checkbox"/>
Tail shaft strap	<input type="checkbox"/>	<input type="checkbox"/>	Fuel lines	<input type="checkbox"/>	<input type="checkbox"/>
Steering	<input type="checkbox"/>	<input type="checkbox"/>	Fluid leaks – oil, water, brake	<input type="checkbox"/>	<input type="checkbox"/>
Headlights & Indicators	<input type="checkbox"/>	<input type="checkbox"/>	Camera	<input type="checkbox"/>	<input type="checkbox"/>

Competitor

Vehicle Passed YES / NO Signed Date.....